

# Front/Side Mount Photoelectric Sensors



## BH Series PRODUCT MANUAL

For your safety, read and follow the considerations written in the instruction manual, other manuals and Autonics website.

The specifications, dimensions, etc. are subject to change without notice for product improvement. Some models may be discontinued without notice.

### Features

- Easy front (M18 nut) and side (M3 bolt/nut) installation
- NPN open collector / PNP open collector simultaneous output
- Sensing distance: Through-beam type 20 m / Polarized retroreflective type 4 m / Diffuse reflective type 1 m, 300 mm
- Small size: W 14 × H 34.5 × L 28 mm
- M.S.R. (Mirror Surface Rejection) function prevents malfunction from reflective objects such as metals or mirrors (polarized retroreflective type)
- Built-in sensitivity adjuster
- Light ON/Dark ON selectable by switch
- Operation indicator (red), stability indicator (green)
- Reverse power protection circuit, output short overcurrent protection circuit
- Mutual interference prevention function (except through-beam type)
- IP67 protection rating (IEC standard)

### Safety Considerations

- Observe all 'Safety Considerations' for safe and proper operation to avoid hazards.
- ⚠ symbol indicates caution due to special circumstances in which hazards may occur.

**⚠ Warning** Failure to follow instructions may result in serious injury or death.

- 01. Fail-safe device must be installed when using the unit with machinery that may cause serious injury or substantial economic loss. (e.g., nuclear power control, medical equipment, ships, vehicles, railways, aircraft, combustion apparatus, safety equipment, crime/disaster prevention devices, etc.)**  
Failure to follow this instruction may result in personal injury, economic loss or fire.
- 02. Do not use the unit in the place where flammable/explosive/corrosive gas, high humidity, direct sunlight, radiant heat, vibration, impact or salinity may be present.**  
Failure to follow this instruction may result in explosion or fire.
- 03. Do not disassemble or modify the unit.**  
Failure to follow this instruction may result in fire.
- 04. Do not connect, repair, or inspect the unit while connected to a power source.**  
Failure to follow this instruction may result in fire.
- 05. Check 'Connections' before wiring.**  
Failure to follow this instruction may result in fire.

**⚠ Caution** Failure to follow instructions may result in injury or product damage.

- 01. Use the unit within the rated specifications.**  
Failure to follow this instruction may result in fire or product damage.
- 02. Use a dry cloth to clean the unit, and do not use water or organic solvent.**  
Failure to follow this instruction may result in fire.

### Cautions during Use

- Follow instructions in 'Cautions during Use'. Otherwise, It may cause unexpected accidents.
- When connecting an inductive load such as DC relay or solenoid valve to the output, remove surge by using diodes or varistors.
- Use the product after 0.5 sec of the power input.  
When using a separate power supply for the sensor and load, supply power to the sensor first.
- 12-24 VDC  $\equiv$  power supply should be insulated and limited voltage/current or Class 2, SELV power supply device.
- Wire as short as possible and keep it away from high voltage lines or power lines to prevent surge and inductive noise.
- When using switching mode power supply (SMPS), ground F.G. terminal and connect a condenser between 0V and F.G. terminal to remove noise.
- When using a sensor with a noise-generating equipment (e.g., switching regulator, inverter, and servo motor), ground F.G. terminal of the equipment.
- This unit may be used in the following environments.
  - Indoors (UL Type 1 Enclosure)
  - Altitude max. 2,000 m
  - Pollution degree 3
  - Installation category II

### Product Components

Sensing type	Through-beam	Polarized retroreflective	Diffuse reflective
<b>Product components</b>	Product, instruction manual		
Reflector	-	MS-2A	-
Adjustment screwdriver	× 1	× 1	× 1
M18 fixing nut / Fixing cap	× 2	× 1	× 1
Bracket	× 2	× 1	× 1
M3 bolt / nut	× 4	× 2	× 2

## Ordering Information

This is only for reference, the actual product does not support all combinations. For selecting the specified model, follow the Autonics website.

**BH** ① - ② **D T**

### ① Sensing distance

Number: Sensing distance (unit: mm)  
Number+M: Sensing distance (unit: m)

### ② Sensing type

T: Through-beam  
P: Polarized retroreflective  
D: Diffuse reflective

## Sold Separately

- Reflector: MS Series
- Retroreflective tape: MST Series

## Cautions during Installation

- Be sure to install this product by following the usage environment, location, and specified ratings. Consider the listed conditions below.
  - Installation environment and background (reflected light)
  - Sensing distance and sensing target
  - Direction of target's movement
  - Feature data
- When installing multiple sensors closely, it may result in malfunction due to mutual interference.
- For installation, tighten the screw with a torque of 0.5 N m. Mount the brackets correctly to prevent the twisting of the sensor's optical axis.
- Do not impact with a hard object or bend the cable excessively. That could decrease the product's water resistance.
- Use this product after the test. Check whether the indicator works appropriately for the positions of the detectable object.

Through-beam	Reflector Reflective	Reflective
Emitter - Receiver: Install to face each other	Sensor - Reflector: At least 0.1 m apart, install to face each other (parallel with the sensing side of the unit)	Sensor - Sensing target: Install to face each other (parallel with the sensing side of the unit)

## Setting Operation Mode

- Be sure to set the mode before power-on.
- Use the offered adjustment screwdriver. Do NOT turn with excessive force to prevent product damage.

L: Light ON mode	D: Dark ON mode

## Operation Timing Chart

### Light ON mode

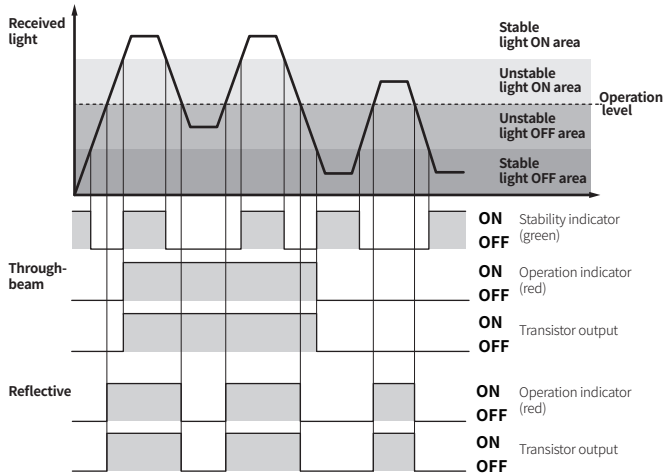

- In Dark ON mode, the waveforms are reversed.
- Operation indicator and transistor output differ from the sensing method.

## Connections

### Emitter

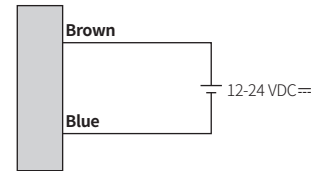

### Receiver, Polarized retroreflective, Diffuse reflective type

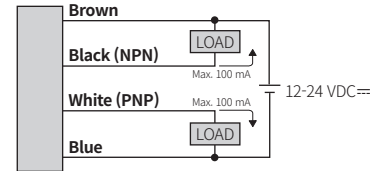

## Circuit

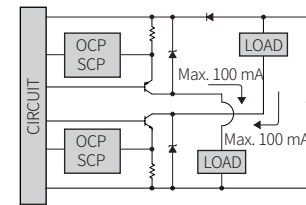

- OCP (over current protection), SCP (short circuit protection)
- If short-circuit the control output terminal or supply current over the rated specification, normal control signal is not output due to the protection circuit.

## Sensitivity Adjustment

- Set the adjuster for stable Light ON area, minimizing the effect of the installation environment.
- Use the offered adjustment screwdriver. Do NOT turn with excessive force to prevent product damage.
- The steps below are based on Light ON mode.

STEP	Status	Description
01	Received	Turn the adjuster from MIN (-) to MAX (+) sensitivity and check the position (A) where the operation indicator activates under the light ON area.
02	Interrupted	Turn the adjuster from (A) to MAX (+) and check the position (B) where the operation indicator activates under the light OFF area. If the operation indicator does NOT activate at the MAX (+, maximum sensitivity): MAX = (B).
03	-	Set the adjuster at the mid position between (A) and (B) for optimal sensitivity.

## Dimensions

- Unit: mm, For the detailed drawings, follow the Autonics website.

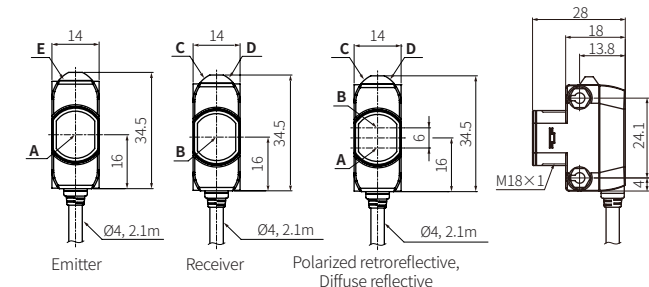

<b>A</b>	Optical axis of emitter	<b>D</b>	Stability indicator (green)
<b>B</b>	Optical axis of receiver	<b>E</b>	Power indicator (green)
<b>C</b>	Operation indicator (red)		

### ■ Reflector (MS-2A)

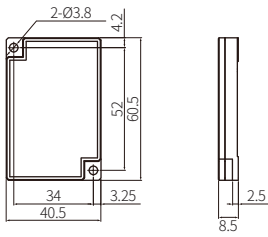

### ■ Bracket

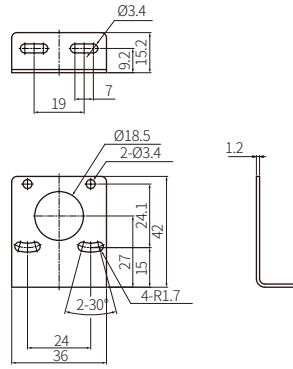

### ■ M18 fixing nut

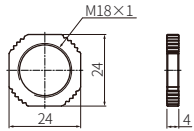

### ■ Fixing cap

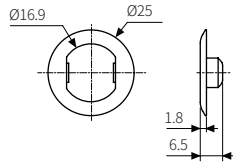

## Specifications

Model	BH20M-TDT	BH4M-PDT	BH□-DDT	
Sensing type	Through-beam	Polarized retroreflective	Diffuse reflective	
Sensing distance	20 m	4 m <sup>(01)</sup>	300 mm <sup>(02)</sup>	1 m <sup>(03)</sup>
Sensing target	Opaque materials	Opaque materials	-	
Min. sensing target	≥ Ø 20 mm	≥ Ø 75 mm	-	
Hysteresis	-	-	≤ 20% of sensing distance	
Response time	≤ 1 ms			
Light source	Red	Red	Red	Infrared
Peak emission wavelength	660 nm	660 nm	660 nm	850 nm
Sensitivity adjustment	YES (Adjuster)	YES (Adjuster)	YES (Adjuster)	
Mutual interference prevention	-	YES	YES	
Operation mode	Light ON mode - Dark ON mode selectable (Adjuster)			
Indicator	Operation indicator (red), stability indicator (green), power indicator (green) <sup>(04)</sup>			
Approval	CE  ENEC	CE  ENEC	CE  ENEC	
Unit weight (packaged)	≈ 120 g (≈ 190 g)	≈ 60 g (≈ 140 g)	≈ 60 g (≈ 130 g)	

- 01) Reflector (MS-2A)  
 02) Non-glossy white paper 100 × 100 mm  
 03) Non-glossy white paper 300 × 300 mm  
 04) Only for the emitter

Power supply	12-24 VDC± ±10% (ripple P-P: ≤ 10%)
Current consumption	It depends on the sensing type
Through-beam	Emitter: ≤ 20 mA, receiver: ≤ 20 mA
Polarized retroreflective	≤ 30 mA
Diffuse reflective (300 mm)	≤ 30 mA
Diffuse reflective (1 m)	≤ 35 mA
Control output	NPN open collector - PNP open collector simultaneous output
Load voltage	≤ 26.4 VDC±
Load current	≤ 100 mA
Residual voltage	NPN: ≤ 1 VDC±, PNP: ≤ 2.5 VDC±
Protection circuit	Reverse power protection circuit, output short overcurrent protection circuit
Insulation resistance	≥ 20 MΩ (500 VDC± megger)
Dielectric strength	1,000 VAC~ 50/60 Hz for 1 min
Vibration	1.5 mm double amplitude at frequency of 10 to 55 Hz (for 1 min) in each X, Y, Z direction for 2 hours
Shock	500 m/s <sup>2</sup> (≈ 50 G) in each X, Y, Z direction for 3 times
Ambient illuminance (receiver)	Sunlight: ≤ 11,000 lx, incandescent lamp: ≤ 3,000 lx
Ambient temperature	-25 to 55 °C, storage: -40 to 70 °C <sup>(01)</sup> (no freezing or condensation)
Ambient humidity	35 to 85 %RH, storage: 35 to 85 %RH (no freezing or condensation)
Protection rating	IP67 (IEC standard)
Connection	Cable type
Cable spec.	Ø 4 mm, 4-wire (Emitter: 2-wire), 2.1 m
Wire spec.	AWG24 (0.08 mm, 40-core), insulator outer diameter: Ø 1.03 mm
Material	Case: PC, CAP: PC, sensing part: PMMA

01) UL approved ambient temperature 40°C

## Feature Data: Through-beam Type

### ■ Sensing area

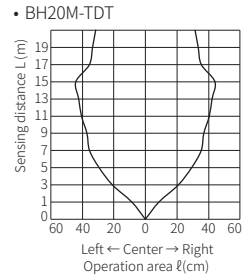
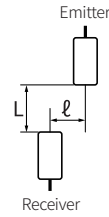

### ■ Emitter angle

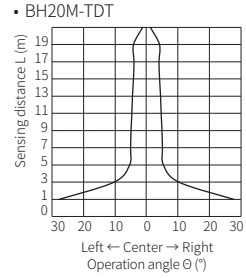
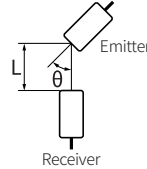

## Feature Data: Polarized Retroreflective Type

### ■ Sensing area

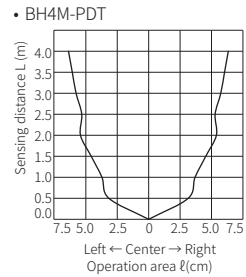
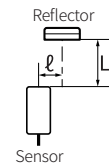

### ■ Sensor angle

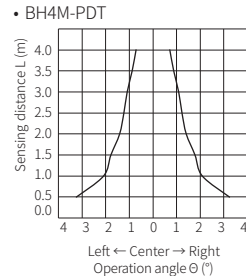
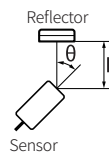

### ■ Reflector angle

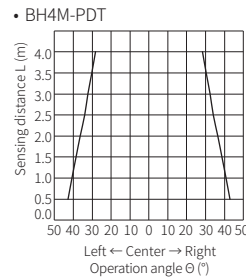
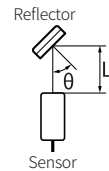

## Feature Data: Diffuse Reflective Type

### ■ Sensing area

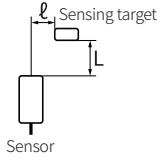

#### • BH300-DDT

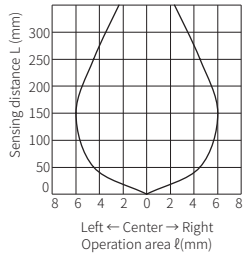

#### • BH1M-DDT

